

St Kilian's School Master Plan (draft) 2018.

PREP COHORT

New Build

- Internal toilets, dedicated wet area.
- Outdoor learning environment (overseen from the classroom learning areas).
- Nature lighting.
- Small glazed working areas / room.
- Easy access - no large steps.
- Large outside display areas.
- Remove old platform (tripping hazard)
- Height of top shelves appropriate for Preps
- Audio System - speakers / microphone

SUPPORT SPACES - PREP and Years 1 & 2

Major Refurbishment

- Shared resource area for Prep, Years 1&2 Staff, including printers, layout space, storage etc.
- Office space / interview room adjoining classroom.

JUNIOR UNIT COHORT - Years 1 & 2

Major Refurbishment

- Internal toilets, dedicated wet area.
- Visual connection to outdoor learning area.
- Nature lighting.
- Small glazed working areas / room.
- Main learning environment which accommodates large, medium and smaller cohort groups.

MIDDLE UNIT COHORT - Years 3 & 4

Major Refurbishment

- Internal toilets, including wet area and kitchenette.
- Outdoor learning environment, visible from the classroom areas.
- Nature lighting.
- New interactive screens, including audio systems.
- Glazed, small working areas / rooms.
- Bench space at standing or stool height around the classroom.
- Multipurpose space that can be accessed for teaching (resources include chairs, screen / whiteboard etc.)
- Review possible mezzanine opportunity.
- Staff resource area, including printers, layout space, storage etc.
- Office space / interview room adjoining classroom.

ADMINISTRATION AND SUPPORT SERVICES

Minor Refurbishment

- Administration clearly visible from the Havelock Street entry 'Front of School'
- Administration spaces require review - both office space and staff space.
- Administration spaces - concealed work spaces to maintain privacy.
- Stalk Bay to allow direct supervision by admin. staff
- Resource / storage areas.
- Clear view of School entry from administration desk / area.
- Principal / Deputy Principal / Bursars Office to be reviewed.
- Interview room adjoining administration area.

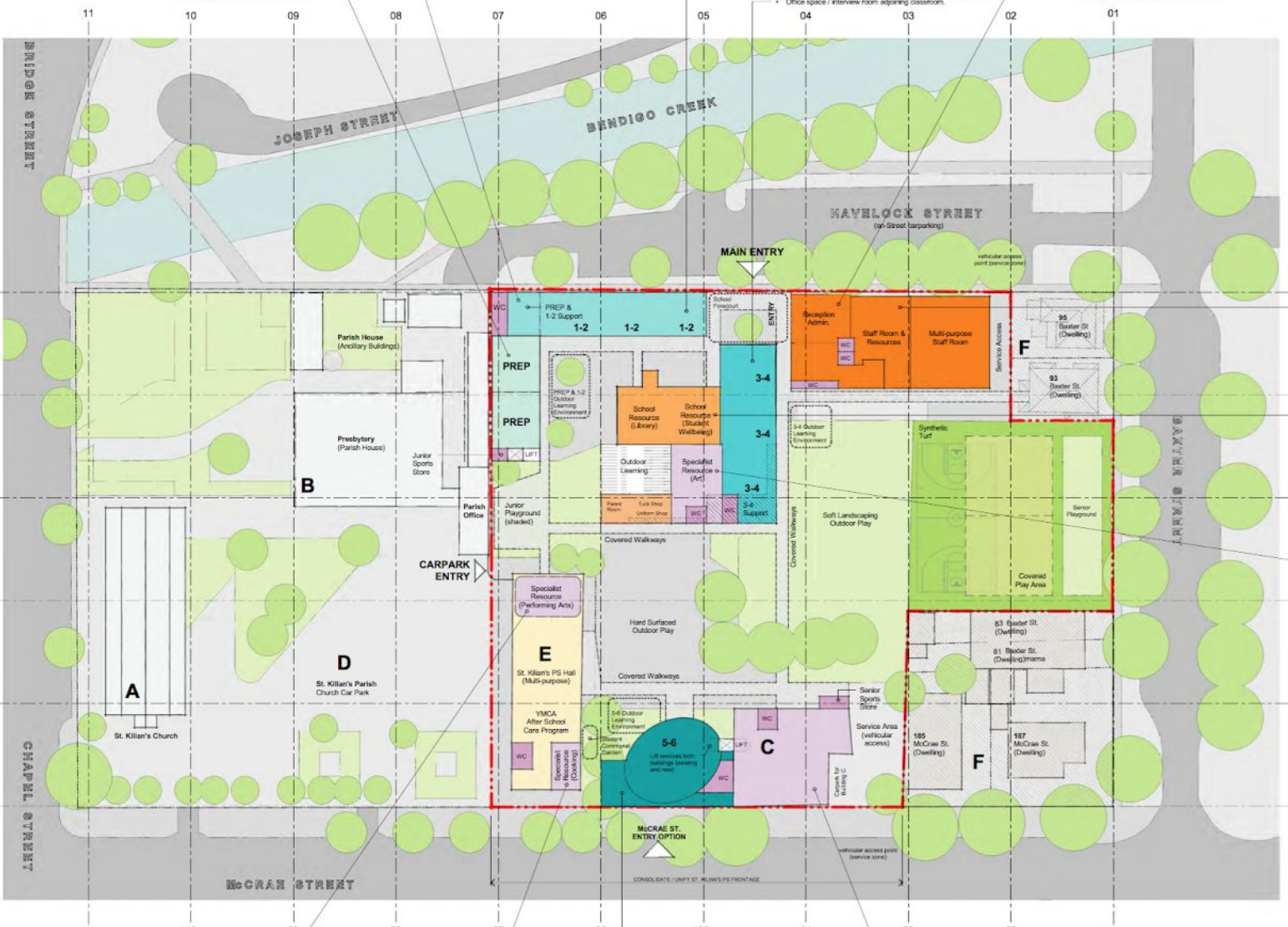

NOTES:
 ALL NEW SCALE 1:500 DIMENSIONS
 ALL PART OF THIS MAP IS TO BE USED IN ACCORDANCE WITH THE ACTING CONTRACT
 Copyright 2018 Brear Architects Pty. Ltd. All rights reserved.



FUNCTION LEGEND

- Prep
- Cohort 1-2
- Cohort 3-4
- Cohort 5-6
- Administration / Resource
- Library / Student Wellbeing
- Tuck Shop / Uniform Shop
- Multi-purpose
- Hall
- Specialist
- Amenities (WC) / Store
- Future Land Acquisition plan to be considered. Properties acquired may be leased until such time as development plans are formulated.

STAFF ROOM

Minor Refurbishment

- Staff table facilities (larger than existing)
- Lockers for handbags & personal items.
- Private casual staff space that allows for socialising and relaxing as a group.
- Staff space to have an interface with the external spaces.

STAFF RESOURCES

- Planning area for staff (including staff resources)
- Staff resource room - teachers hub (size of a classroom)
- Central location of staff resources.
- One meeting room for 10+ persons.

LEARNING SUPPORT

Student Wellbeing

- Space for support services - catering for small group gatherings.
- Auxiliary space for social workers and speech pathologist (private room).
- Room for parents / interview rooms / private discussion spaces.

Library

- Strong connection to the earlier years - PREP and Years 1 and 2.
- Physical connection to the outdoor learning area.
- Flexible space to accommodate individual, small and larger student groups.

SPECIALIST AREAS

New Build / Major Refurbishment

- Science - Science facilities for Senior Unit.
- Art - Separate ASC area, Teacher area / office separate to store room, Access to external environment, Wet area - taps and basins.

EXTERNAL SPACES

- Establish a stronger front entry / forecourt for the School - main entry being Havelock Street.
- Enhance entrance / exit from the Church carpark.
- Establish outdoor learning environments for each of the junior, middle and senior student units.
- Further develop grass areas for group / team play.
- Enhance hard surface outdoor play areas.
- Increase shade areas through trees, covered walkways, shadeports etc.
- Link buildings through covered walkways.
- Enhance external areas to support School assembly.
- Create a 'stage' for performance play.
- Establish parents room - coffee machine, baby change facilities, parent toilets etc.
- Clear signage across the School areas & school entrance.
- Recycling water to gardens.
- Future growth through Pre-School / Kinder Program
- Upgraded playground with equipment such as obstacle course i.e. ropes, balance beams, climbing frame/wall
- Increase seating across the campus.
- Better public lanes.
- Communal garden (kitty garden for junior years)
- Permanent storage for play equipment especially around the sandpit toys.
- Open ended play areas / natural resources
- Access for water play.

SITE LEGEND

- A. St. Kilian's Church
- B. St. Kilian's Presbytery
- C. Catholic Library Learning Centre
- D. St. Kilian's Church Carpark
- E. St. Kilian's PS Hall
- F. Future Expansion Opportunity

brear architects.
 PO BOX 1200 Hawthorn VIC 3122 AUSTRALIA
 PH 03 9594 1200
 www.breararchitects.com

St. Kilian's Primary School

St. Kilian's PS Masterplan 2016

2 Frankston Street, Stoney Creek VIC 3009

Site Layout - Proposed

Scale 1:500

DATE: 2017-11
 DRAWN: JMB
 CHECKED: JMB
 APPROVED: PJ (Principal) & AT (Architect)
 DATE: February 2018

MP.03

SPECIALIST AREAS

Minor Refurbishment

Performing Arts

- Utilise hall and stage to develop students in the performing arts.
- Create dedicated storage space for costumes, props etc.
- Increase use of technologies, including audio visual.
- Integrate Schools technology / telecommunication.

SPECIALIST AREA

Minor Refurbishment

Cooking

- Utilise the commercial kitchen within St. Kilian's hall for cooking.
- Connection to the communal garden.

SENIOR UNIT COHORT - Years 5 & 6

New Build

- Central space to gather - lecture like space, possible tiered seating
- Outdoor learning environment.
- Multi-purpose room regular access for teaching groups with access to chairs/tables and whiteboard
- Quiet reading area, new couches, beanbags.
- Access to Science, Cooking, Art facilities (refer specialist areas)
- Nature lighting.
- TV screens around room for small focus groups / student led groups.
- Glazed, small working areas.

- Student Communal Garden.
- Block-out blinds for when watching screens.
- Variety of furniture - stand up desks, lower tables, couches, bean bags etc.
- Space for a printer/photocopier - avoiding the need for students to go to admin. hub.
- Foyer made into a learning space - screen etc.
- Revolving Staircase, and digital writing facilities/cases (refer specialist areas)
- Break out seating and areas for students outside the multi-purpose room with doors that raise up rather than windows (indoor/outdoor space)

SPECIALIST AREAS

Major Refurbishment

Option A - building and adjacent land for dedicated carpark

- leased by Diocese as a commercial basis to maintain income stream.

Option B - building re-purposed for specialist learning resources

- (Opportunity for central location to service other Schools / groups within Diocese)

CONFIDENTIAL

B